



01354  
610257

info@piscescountrypark.co.uk  
www.piscescountrypark.co.uk

LODGE - PLOT 5 - PRE-OWNED

# PEMBERTON MARLOW LODGE

38ft x 12ft, 2 Bed, 4 Berth, En-suite

**£72,000 ono**

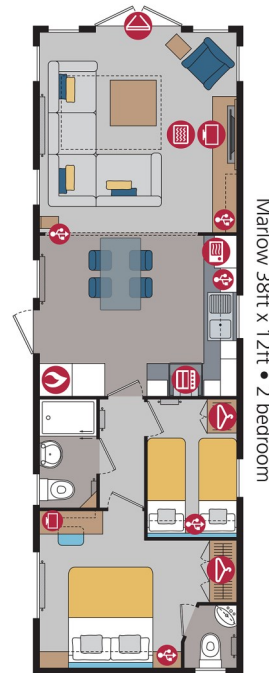

The Marlow, is bright and modern with some new features to look out for. Those seeking an open plan layout with a difference, need look no further. A contemporary L shaped sofa with contrast chair and a dining table with smart upholstered dining chairs complete the look. Comes with air conditioning and satellite TV.

